

PARAMETRIC
STUDIO

NEWTON AR

Analog Clock Kit: Assembly Instructions

Reading not your thing? Don't worry, we got you ... thankfully we made a video! To watch the assembly video, go to:

<https://www.newton-ar.com/projectdocs>



Oh, you're still here? Excellent! Videos are overrated anyway ... but if you get stuck make sure to check out the video :)

Cuckoo for Cuckoo Clocks? Today's your lucky day! You will be building an Analog Cuckoo Clock. Cool right? Let's begin!

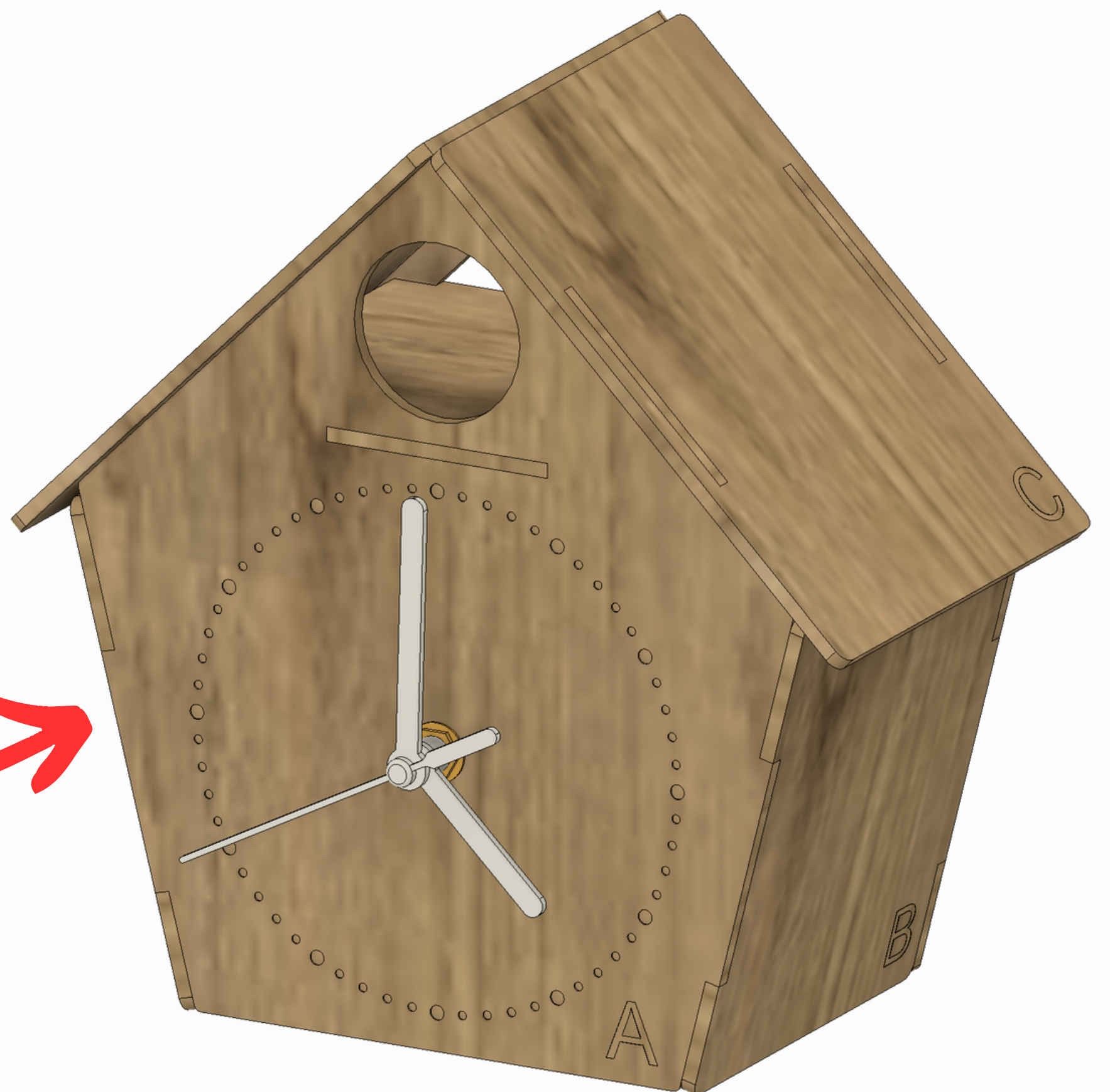

<https://www.parametricstudioinc.com/>

WHAT'S IN THE BOX?

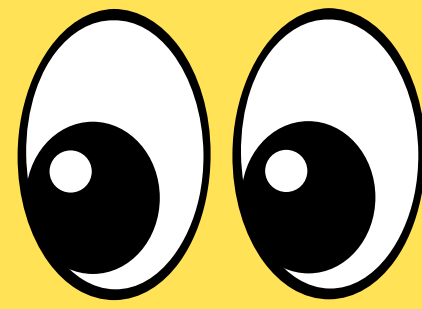

WARNING!
Small Parts
Present



Contents:

- [A] Clock Face (x1)
- [B] Side (x2)
- [C] Roof (x2)
- [D] Frame (x2)
- [E] Roof Bed (x2)

- 01. Minute Hand (x1)
- 02. Second Hand (x1)
- 03. Hour Hand (x1)
- 04. Washer (x1)
- 05. Hex Nut (x1)
- 06. Spacer (x1)
- 07. AA Battery (x1)
- 08. Clock Movement Body (x1)

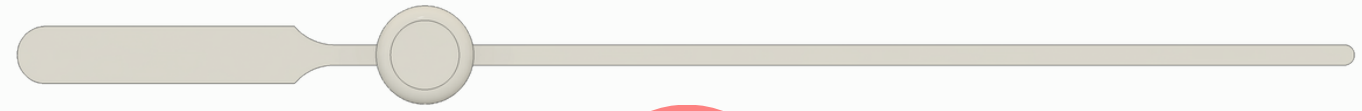

1

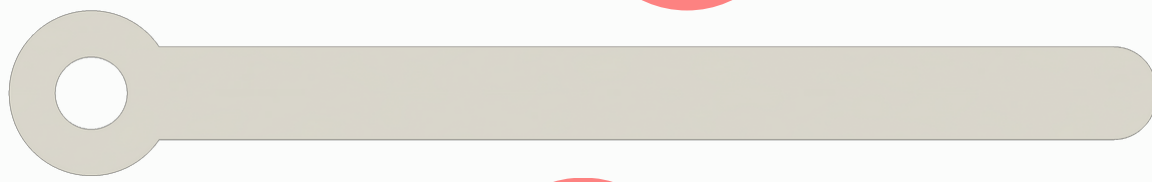

2

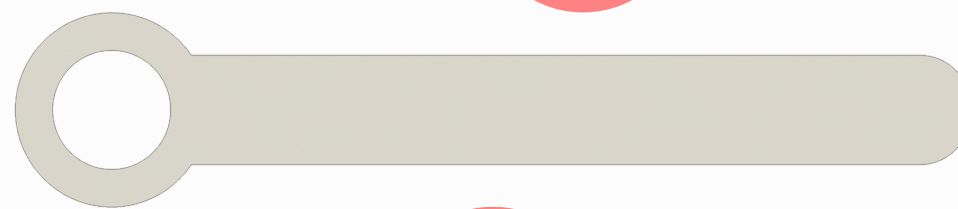

3

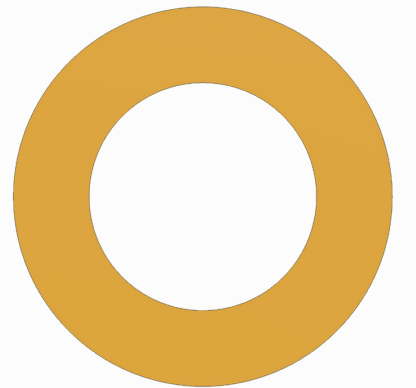

4

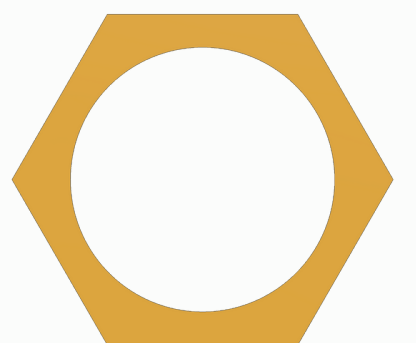

5



7



6



A



C

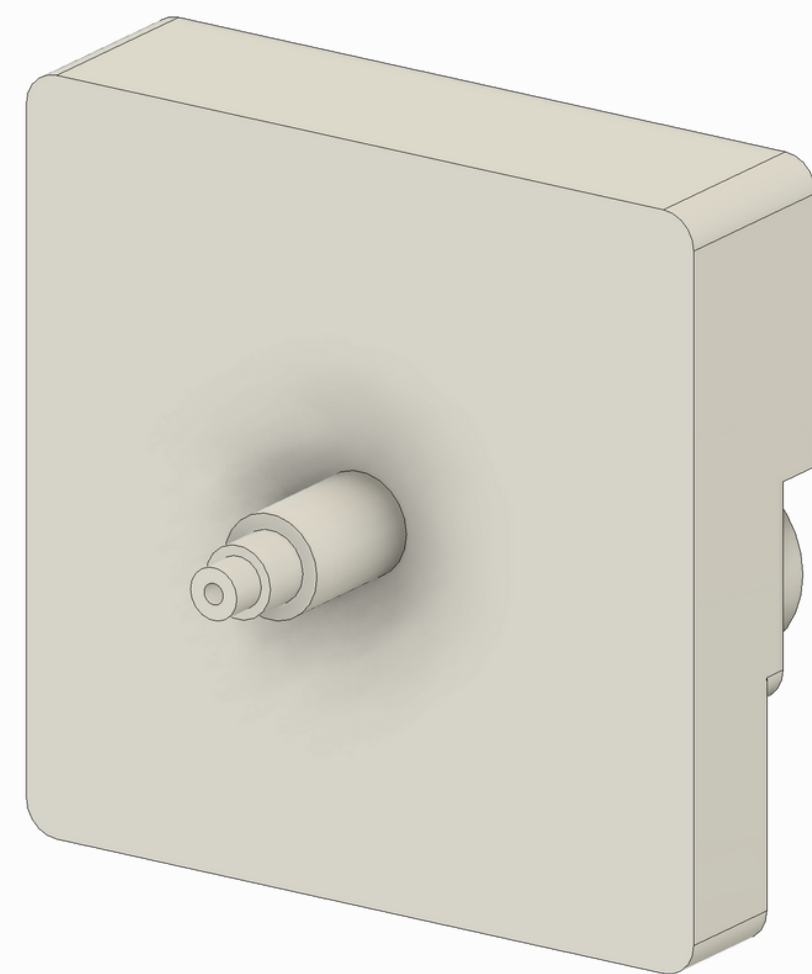

8



B

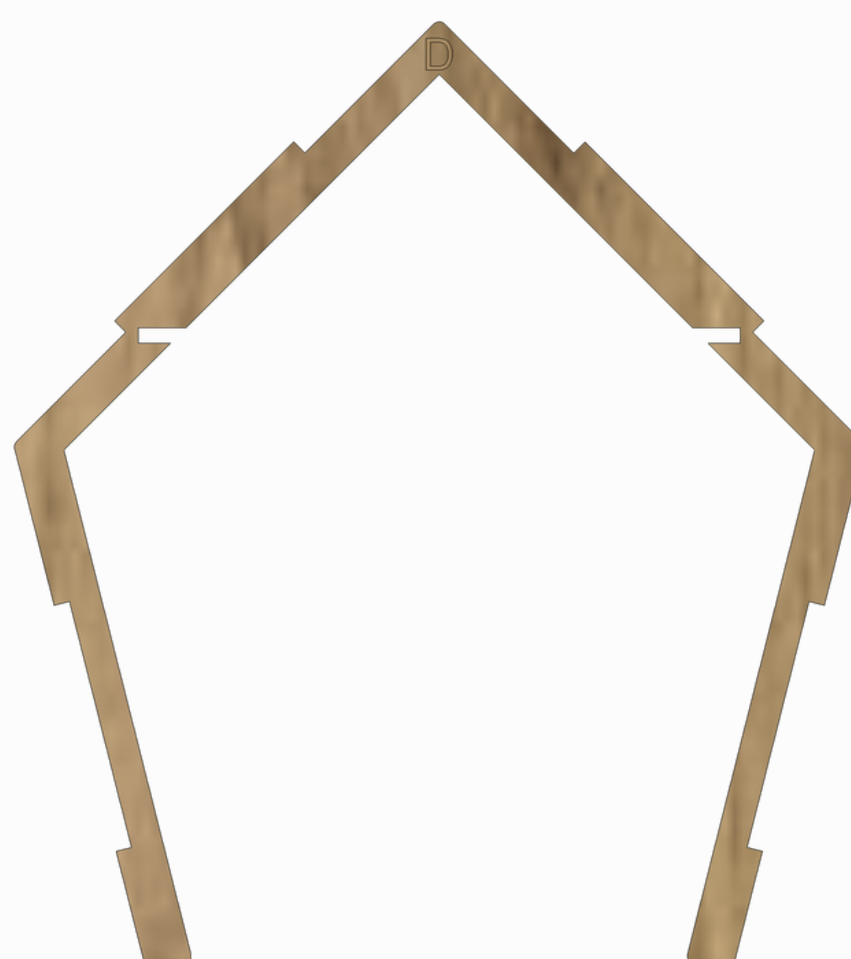

D

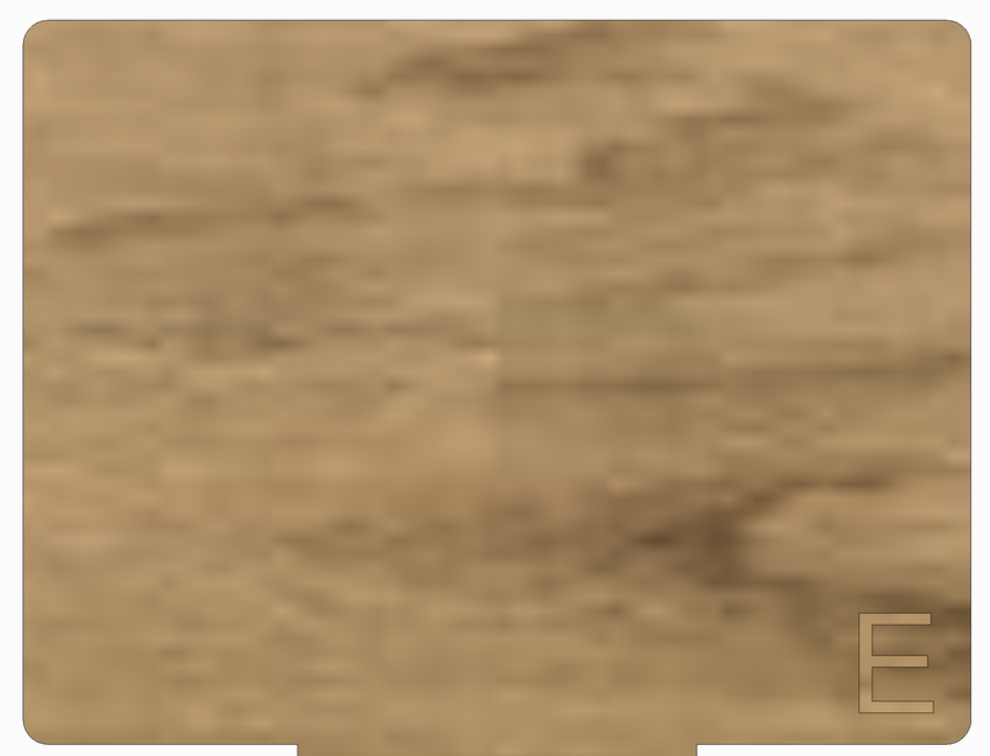

E

Grab: Clock Face (Part A) and O1 Roof (Part C)

1

[AS01] Add Glue to the highlighted areas on Part A and Part C. Then, slide the glued edge of Part A into one slot in Part C. Make sure the tip of Part A is aligned with the end of Part C as shown below.

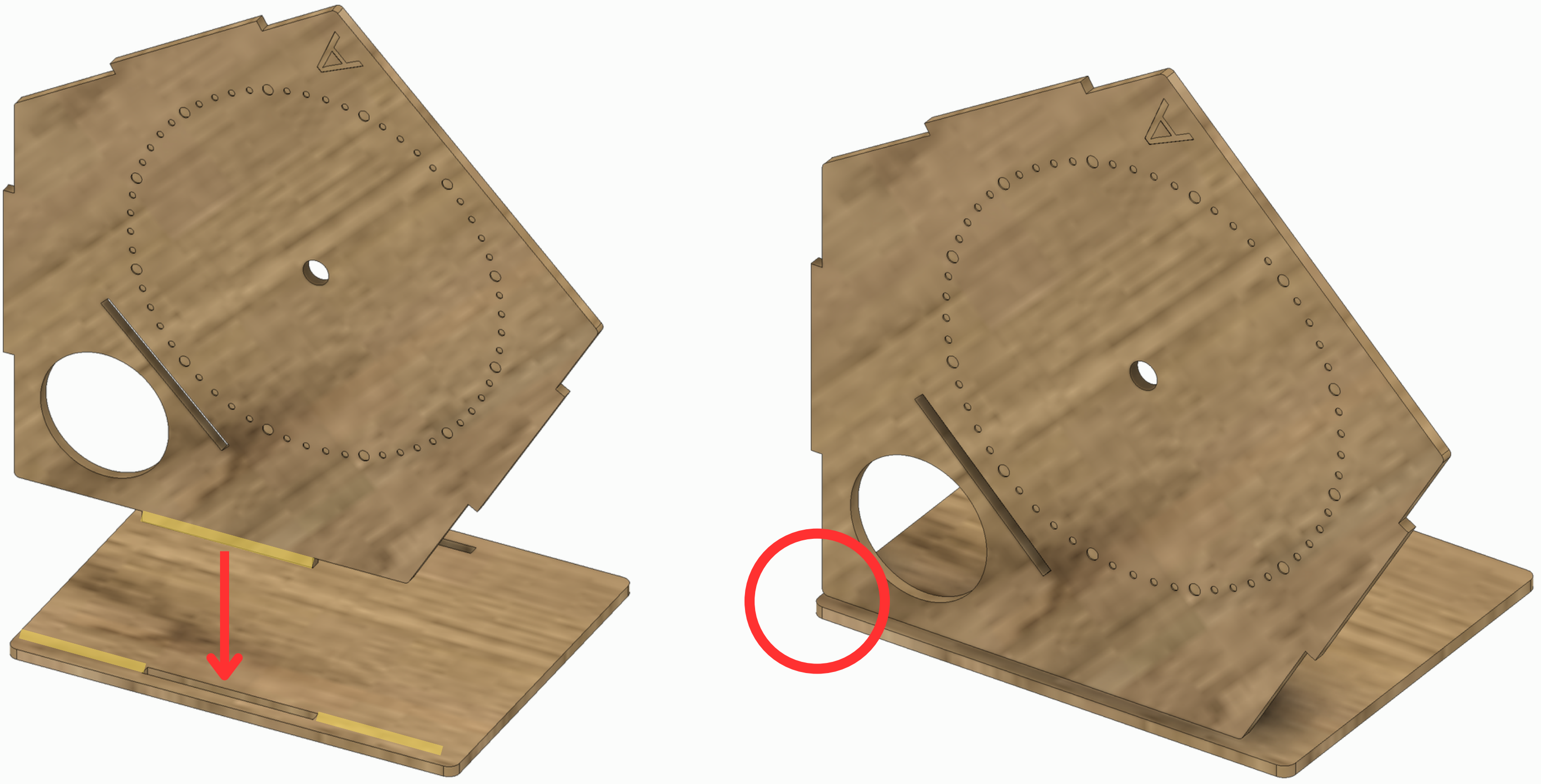

Grab: Frame (Part D) and AS01

2

[AS02] Add Glue to the highlighted areas on Part C and Part D. Then, slide the glued edge of Part D into the remaining slot in Part C. Make sure the pointed edge of Part D is aligned to the end of Part C as shown below.

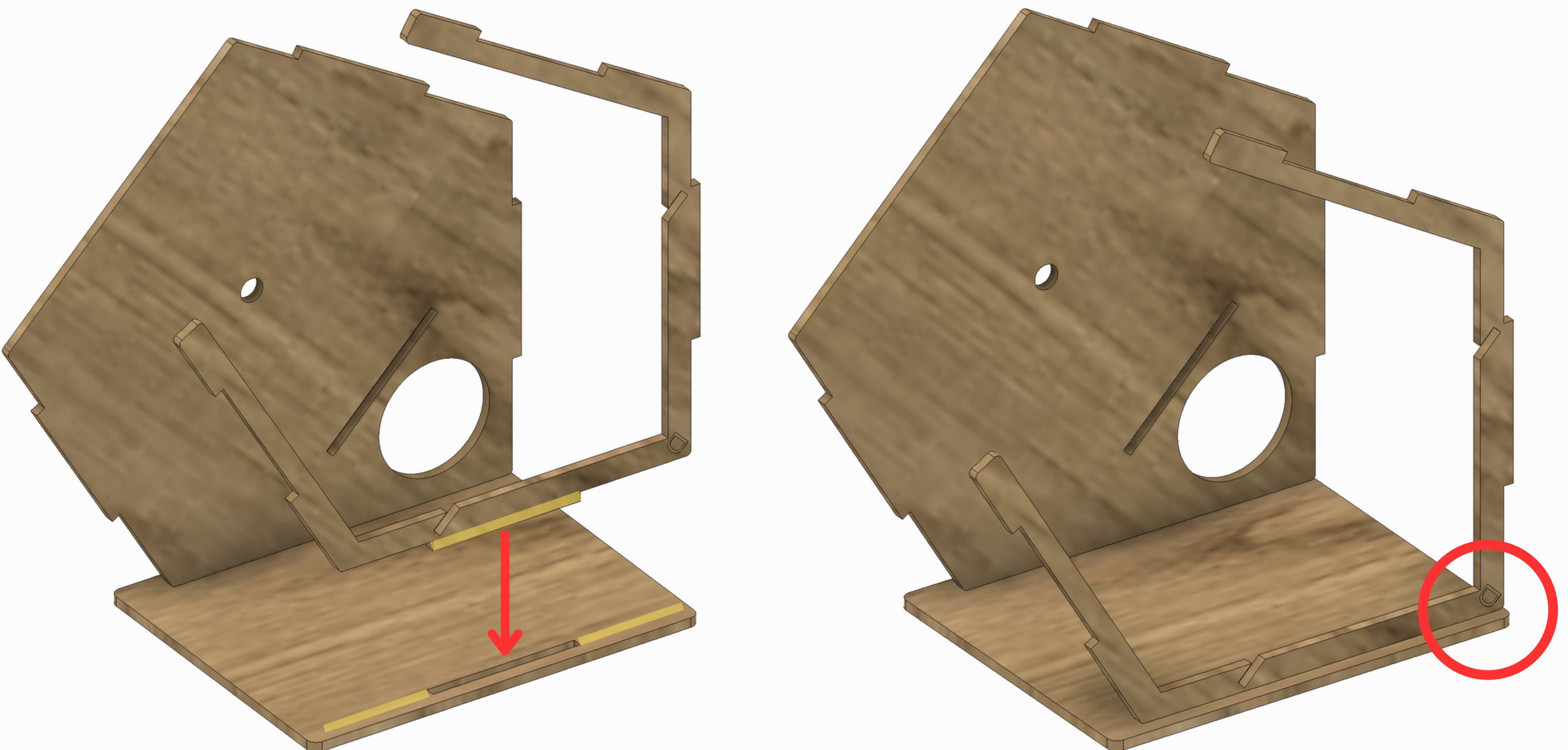

3

Grab: 01 Roof (Part C) and AS02

[AS03] Add Glue to the highlighted areas on Part C and to the tabs on Part A & Part D. Then, slide the glued tabs on Part A & Part D into the slots in Part C. Make sure the pointed edges of Part A and Part D are aligned to the end of each Part C as shown below.

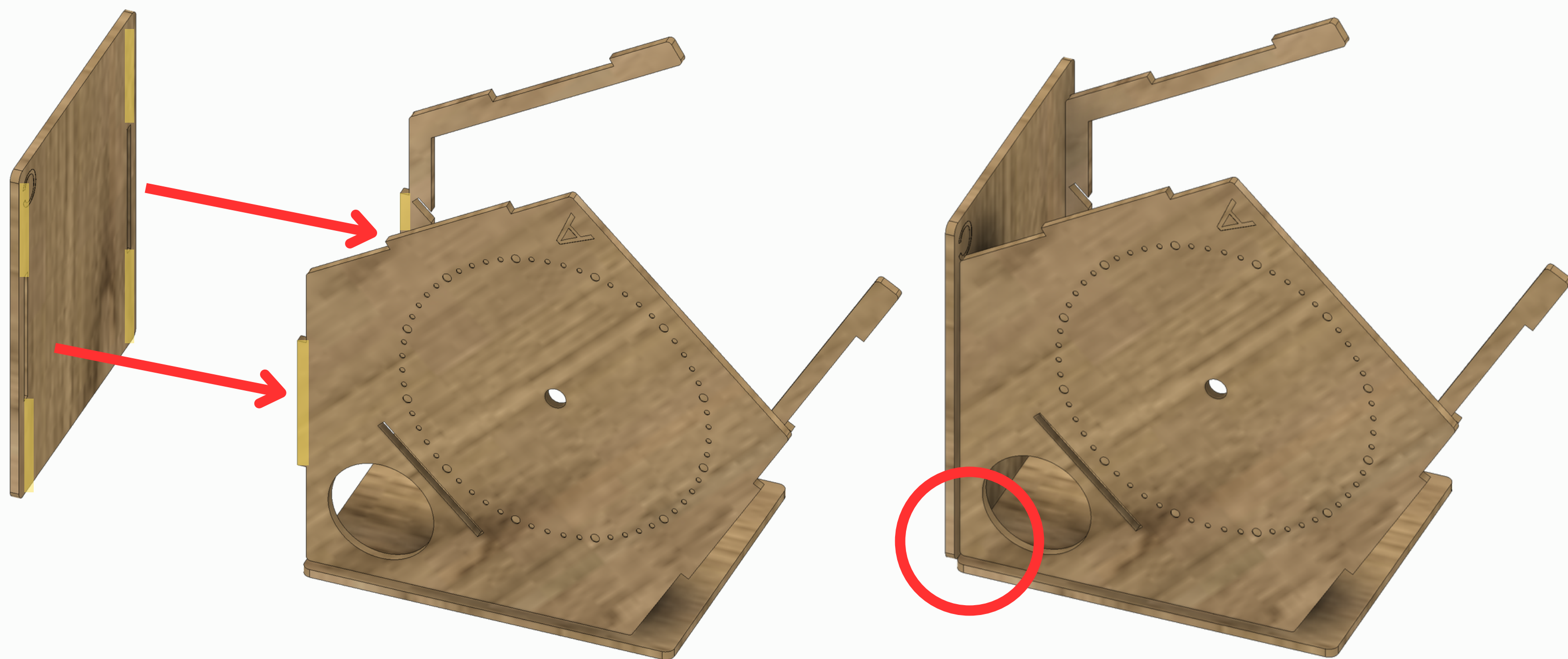

4

Grab: Roof Bed (Part E) and AS03

[AS04] Add Glue onto the tab of Part E and onto the back face of Part A (as highlighted). Then, slide the glued tab of Part E into the slot in Part A (make sure the sides of Part E slide through the notches in Part D.)

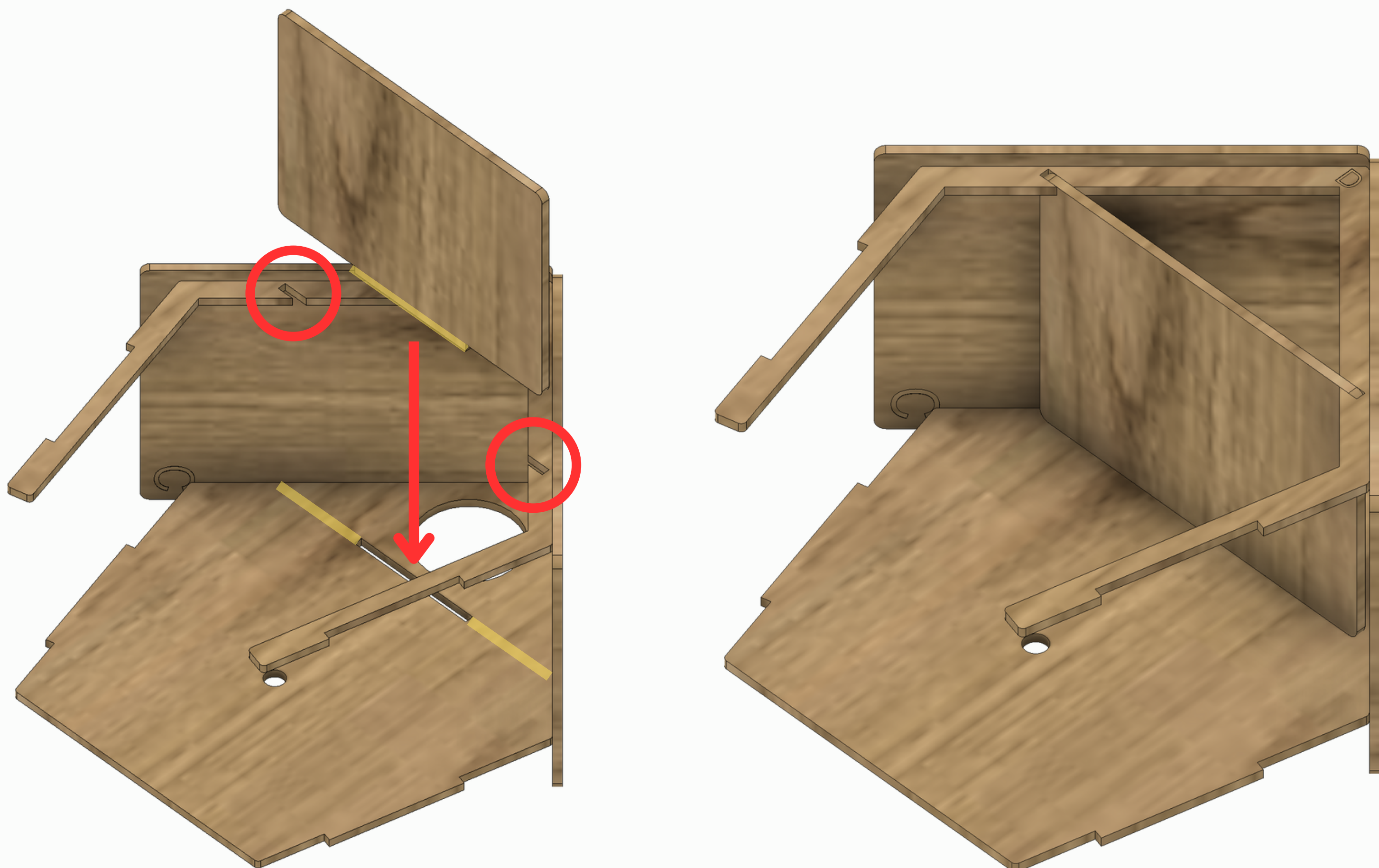

5

Grab: 02 Side (Part B) and AS04

[AS05] Add Glue to the highlighted areas on Part B, onto the notches on Part D, and onto each tab and the edges on Part A. Then, slide the glued tab of Part B into the notch on Part D and the notched end of Part B to the tab in Part A. (Make sure there is no gap between Part B and Part C and that the end of each Part B is aligned to the end of Part A as shown below. Repeat on the other side of AS04.

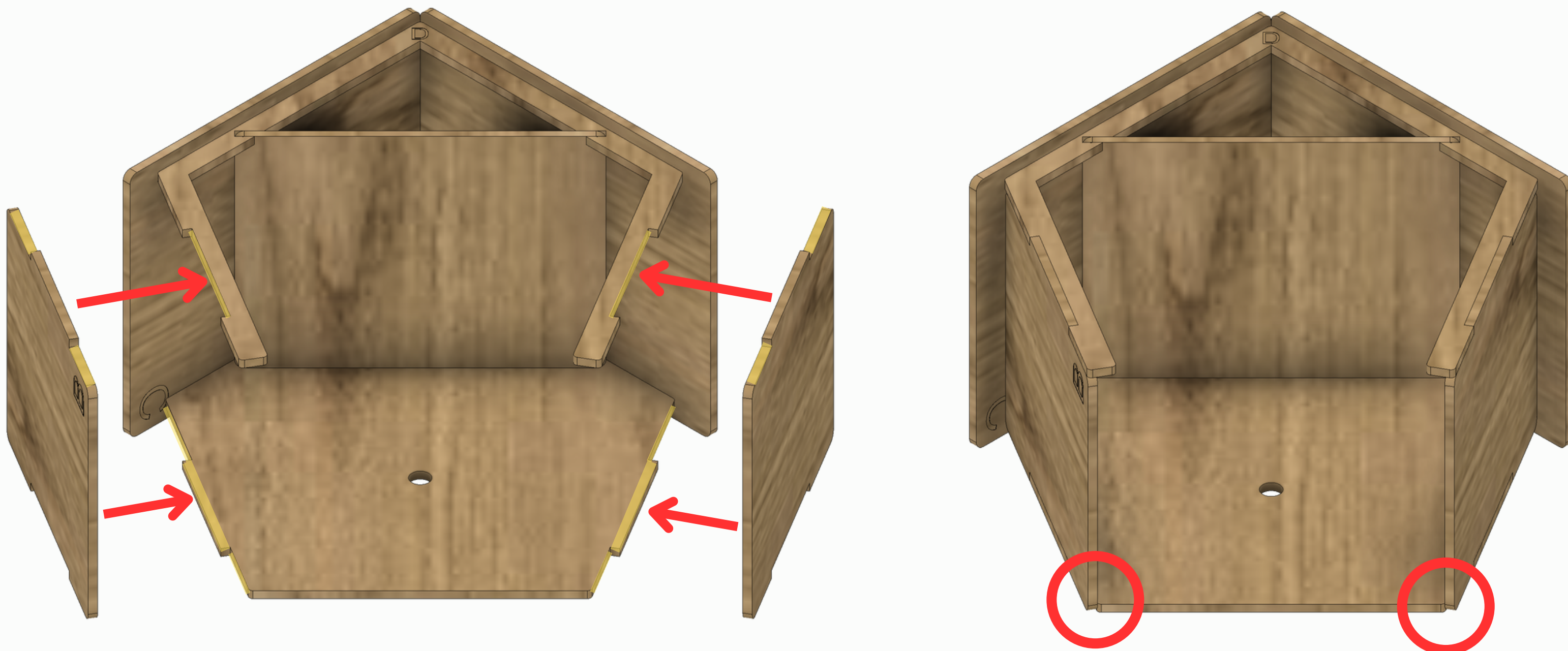

6

Grab: Clock Movement Body (CMB), Spacer, Hex Nut, Washer, and AS05

[AS06] Note: The Clock Movement Body (CMB) and the Spacer will be placed on the back of Part A and the Washer and Hex Nut will be placed on the front of Part A. First, slide the Spacer through the shaft of the CMB. Next, from the back of Part A, slide the shaft of the CMB through the center hole in Part A. Then, slide the Washer through the shaft of the CMB, and then tighten down the Hex Nut to lock everything in place.

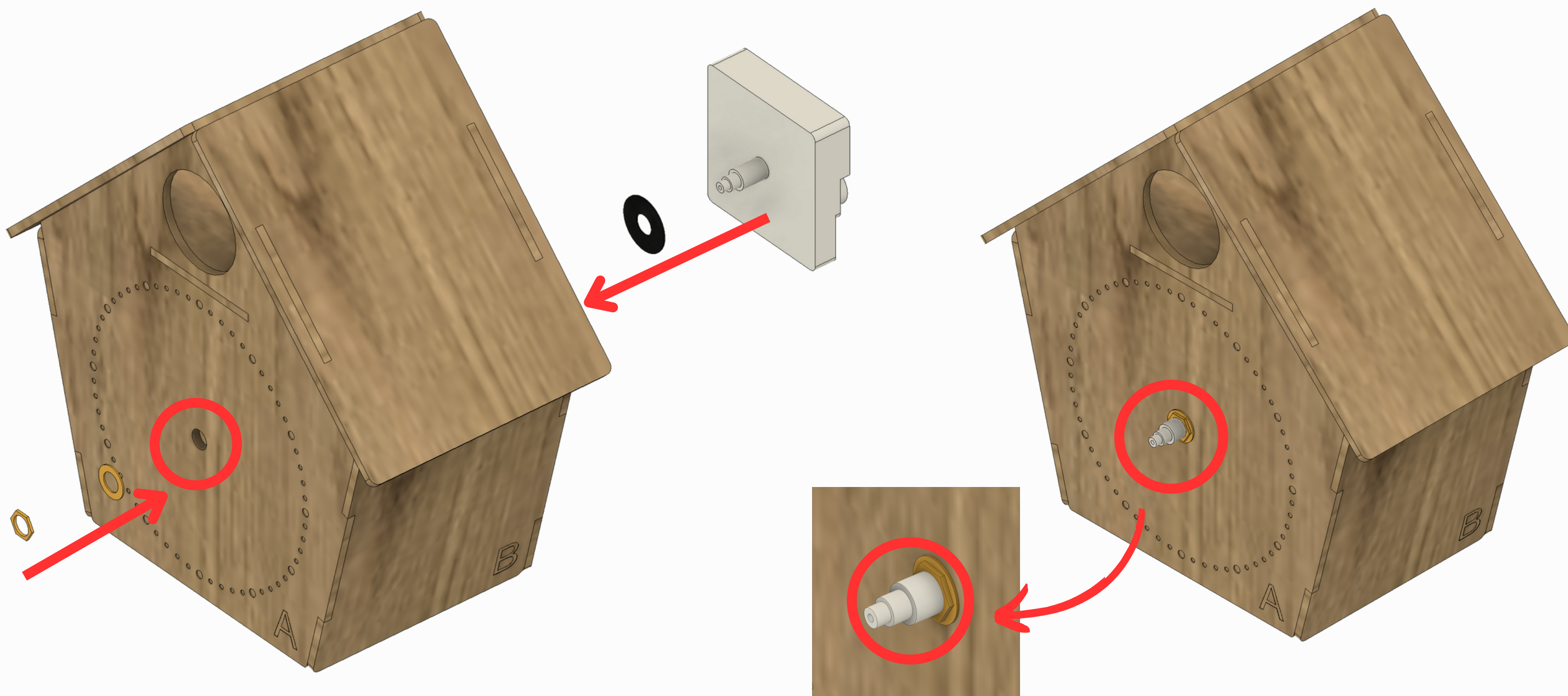

7

Grab: AS06, Hour Hand, Minute Hand, and Second Hand
[AS07] In the order of Hour Hand, Minute Hand, and Second Hand, slide each hand through the shaft of the Clock Movement Body until each lock into place (see image below). Note: A little force may be needed to push each hand down to lock them into place.

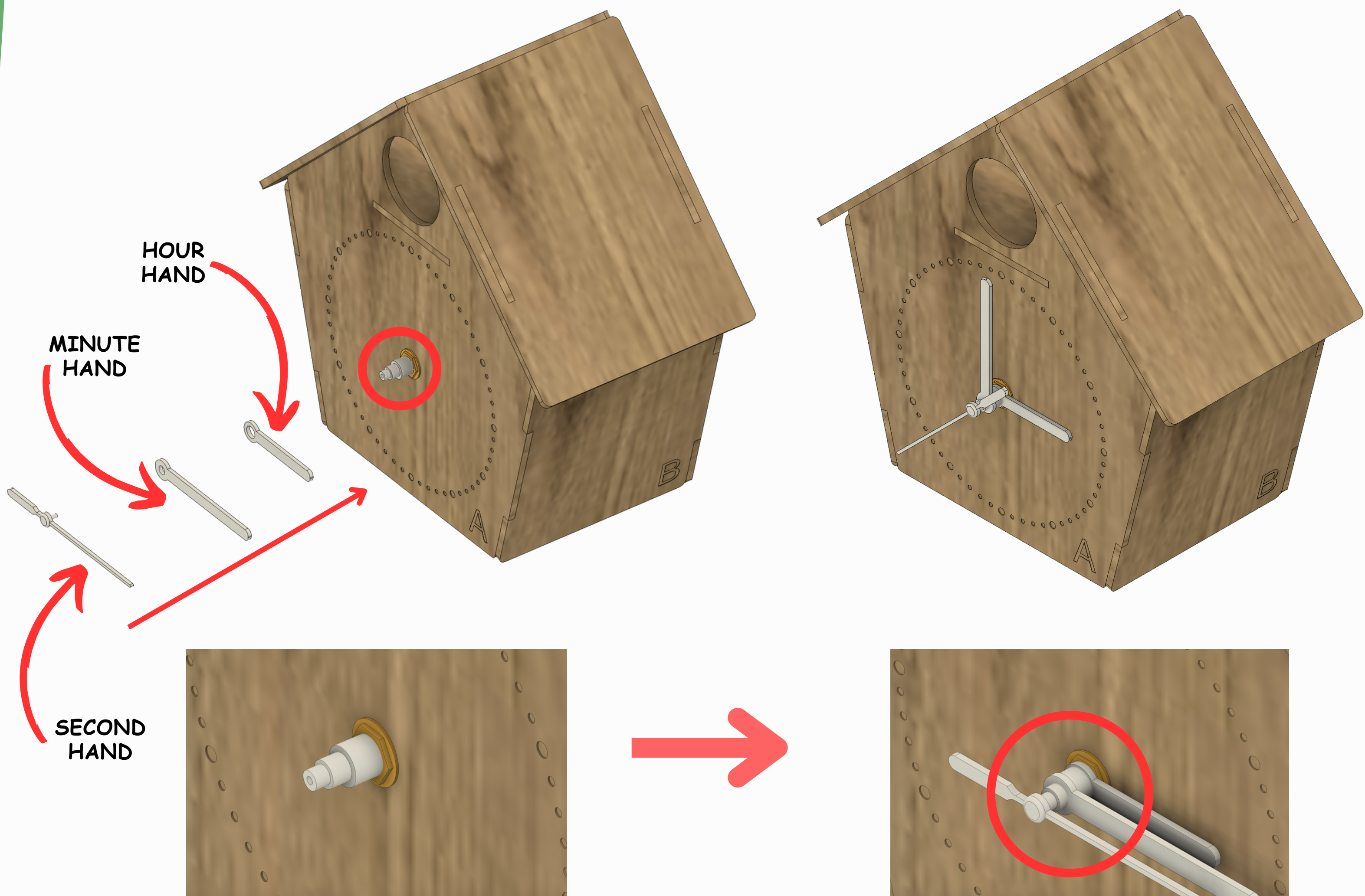

8

Grab: AS07, AA Battery
[AS08] Insert the AA Battery into the battery slot on the back of the Clock Movement Body as shown (Positive (+) end on the Right, Negative (-) end on the Left).

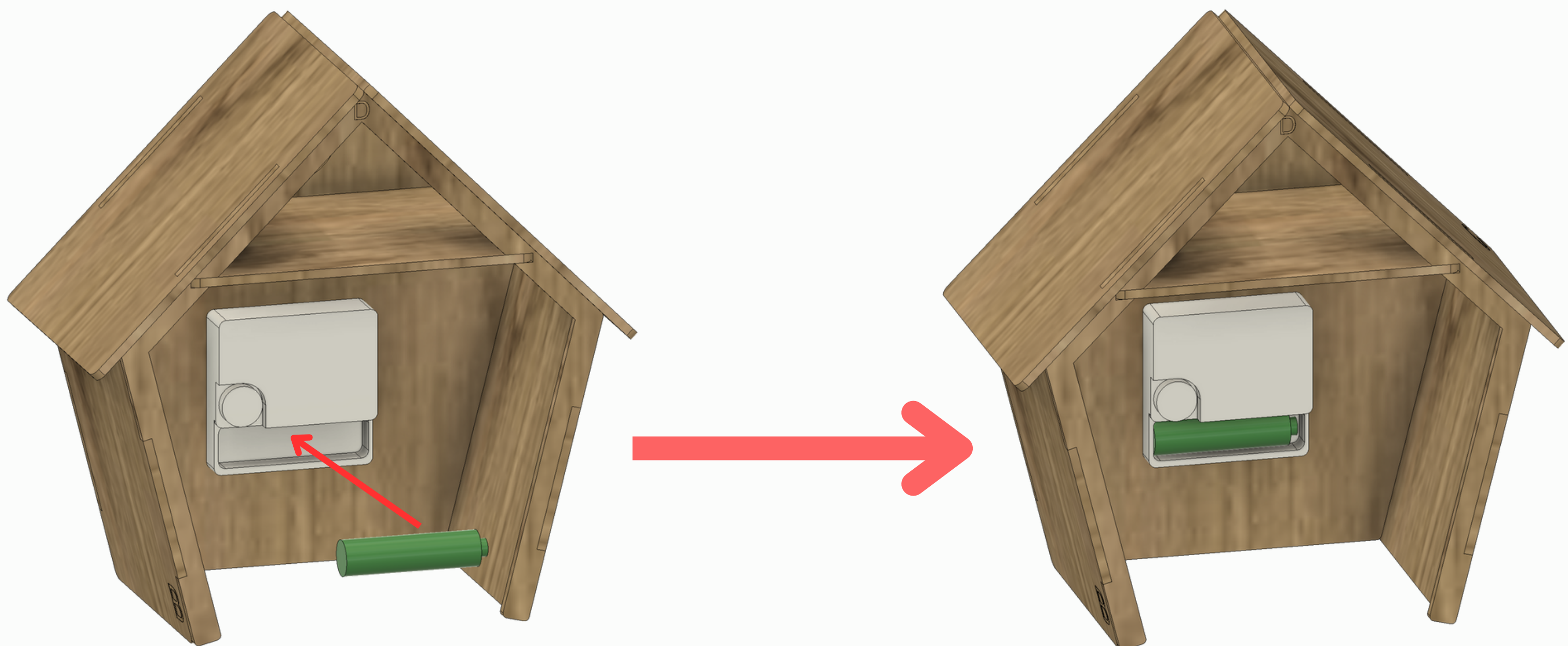

How to Use the Analog Cuckoo Clock

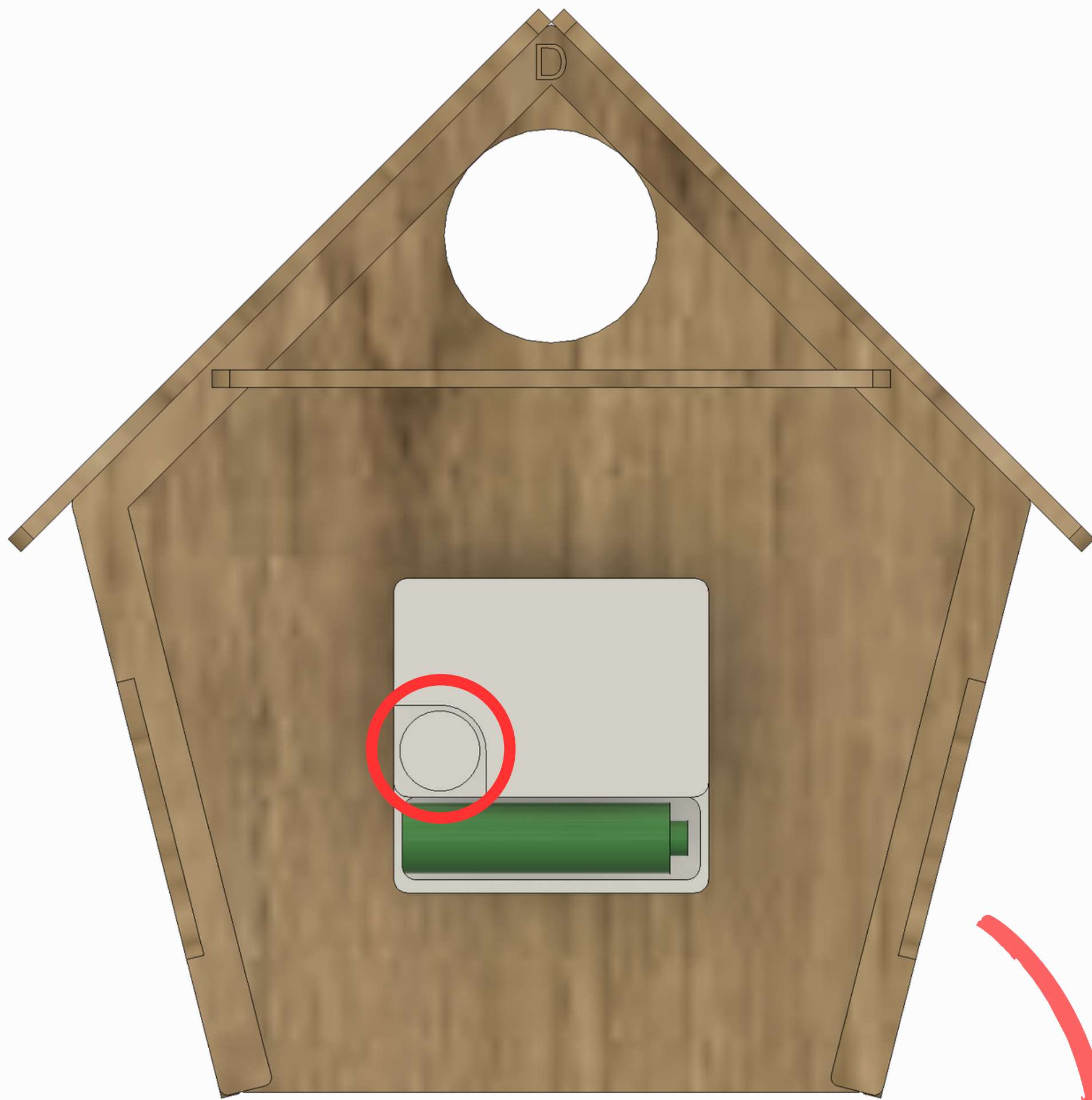

TIP!

How to Use: To Adjust the Time, Turn the Dial on the Back of the Clock Movement Body

Use a Marker, Pencil, or Sharpie to Write the Numbers of the Clock and to Color or Design the Clock However You Want!

